

Checklist

Sage DPW SAML

Please enter the details of the technical contact person:

Company name

Name

Phone

Email

If you have any questions:

Sage DPW

Customer service

+43 1 277 04 111

kundenservice@sagedpw.at

Dear Customer,

thank you for your order! We are delighted that you have chosen Sage DPW. We kindly ask you to provide us with the following technical information.

With regard to encryption and certificates, we recommend using the variant „signed SAML-Response with a signed Assertion“ in conjunction with SAML 2.0. Otherwise you are vulnerable to various attack scenarios.

Below you will find information that you need to set up on your side, for your IDP (Identity Provider), or that we need to set up on our site, the SP (Service Provider).

To make this list clear, checkboxes have been added ☐.

As soon as the necessary information has been entered, the checkbox can be set to „done“ ☒. Example links listed here are from Azure Cloud.

You will need the following information for the technical setup of your IDP (identity provider)

1. Customer number – You will receive your customer number by email.
Note: Please replace them in the following links
2. URL to Sage DPW “metadata.xml” – Please use the following link to obtain SageDPW metadata information (Identifier (Entity ID)):
https://api01.sagedpw.at/saml_customerid_v8p/metadata.xml
3. URL for the Sage DPW Login (Sign on URL):
https://api01.sagedpw.at/saml_customerid_v8p/loginWeb
4. URL for the response to Sage DPW (Reply URL (Assertion Consumer Service URL)):
https://api01.sagedpw.at/saml_customerid_v8p/assert

We will need the following information for the technical setup of Sage DPW

1. Login URL of your IDP. We redirect to this URL from the DPW login page:
e.g. [https://login.microsoftonline.com/\[hash-code\]/saml2](https://login.microsoftonline.com/[hash-code]/saml2)

An example from Azure Cloud:

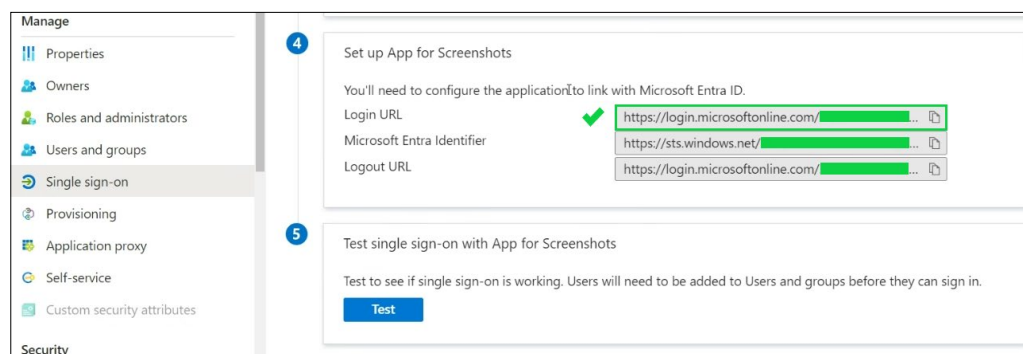

2. Path to the federation metadata.xml of your IDP, is required to exchange certificates:
e. g. [https://login.microsoftonline.com/\[hash-code\]/federationmetadata/\[datum\]/federationmetadata.xml?appid=\[hash-code\]](https://login.microsoftonline.com/[hash-code]/federationmetadata/[datum]/federationmetadata.xml?appid=[hash-code])

An example from Azure Cloud:

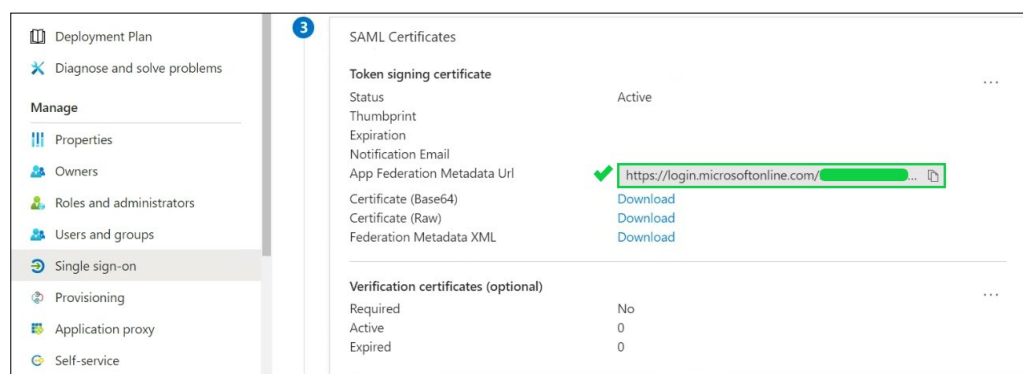

3. In order to be able to test SAML on Sage, the login must work with the IDP test user. In addition to the IDP login, it is also necessary to be able to log in to SageDPW Web. This requires that a corresponding SageDPW Web user exists who has stored the email address of the IDP user (under Technology - Authorization - User Management > WDB article: 213858). If this user does not exist, Sage cannot test a SAML login:

Username

DOMAIN\username

Password

Define the email address as „Unique User Identifier“ in the assert

We need the email address in the „Unique User Identifier“ to find the right user within Sage DPW. The mapping with Sage DPW is done via the email address. The following screenshots are examples of configuration in Azure Cloud:

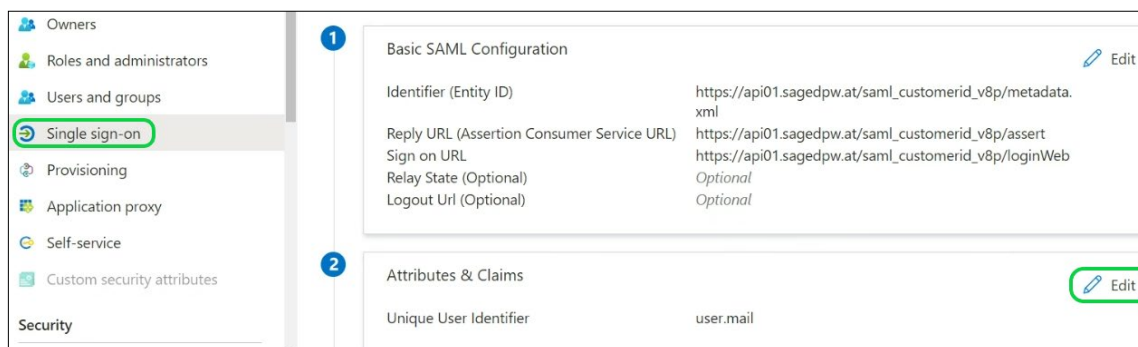

After clicking on „Edit“ the following mask appears:

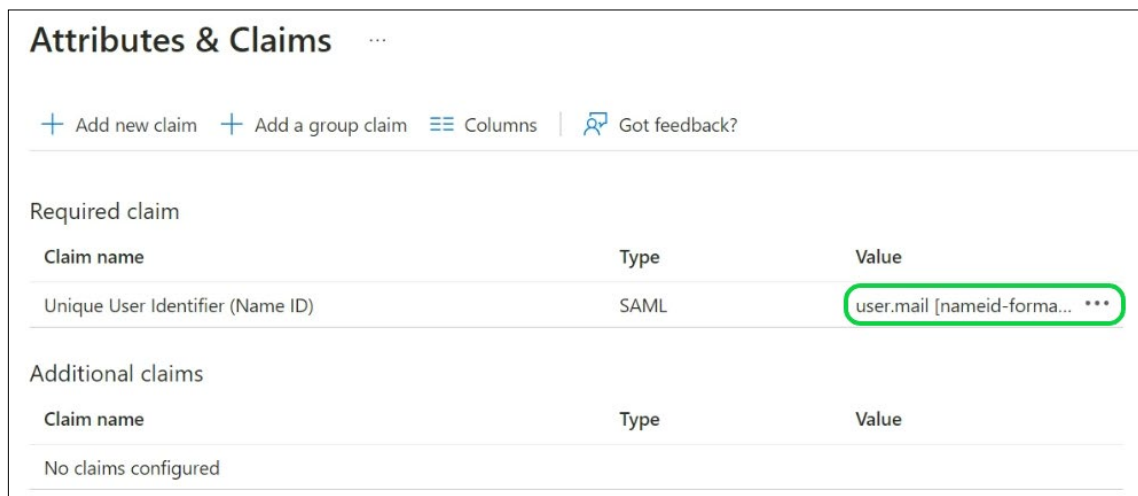

If you click on these 3 dots, the following mask appears:

Manage claim

Save

Discard changes

Got feedback?

Name

nameidentifier

Namespace

Choose name identifier format

Name identifier format

Email address

Source

Attribute

Transformation

Directory schema extension (Preview)

Source attribute

user.mail

In Azure Cloud, the configuration would look like this:

Owners

Roles and administrators

Users and groups

Single sign-on

Provisioning

Application proxy

Self-service

Custom security attributes

Security

1

Basic SAML Configuration

Identifier (Entity ID)

https://api01.sagedpw.at/saml_customerid_v8p/metadata.xml

Reply URL (Assertion Consumer Service URL)

https://api01.sagedpw.at/saml_customerid_v8p/assert

Sign on URL

https://api01.sagedpw.at/saml_customerid_v8p/loginWeb

Relay State (Optional)

Optional

Logout Url (Optional)

Optional

2

Attributes & Claims

Unique User Identifier

user.mail

Sage

SAGE DPW SAML – CHECKLIST

4



Sage GmbH

Stella-Klein-Löw-Weg 15
1020 Vienna

+43 1 277 04
info@sagedpw.at

www.sagedpw.at

Sage GmbH is the leading provider of HR management software with the Sage DPW product range. With our comprehensive product portfolio, we offer software solutions for all areas of human resources. Sage DPW software is implemented at over 1,000 customers, from medium-sized to multinational companies, in a wide range of industries.



Sage

©2024 Sage GmbH. All rights reserved. Sage, the Sage logo and Sage product names mentioned herein are registered trademarks of Sage Group plc or its licensors. All other brand names are the property of their respective owners. Subject to technical, formal and typographical changes.